

— THE —
ATKIN
—
Events Centre





Located at 40 Main Avenue, Coorparoo, Easts Leagues Club is perfectly situated within kilometers of the Brisbane CBD.

A 15-minute car ride from the city, or 20 minutes by bus with local public transport stops within short walking distance of The Club.

With plenty of on-site parking and a private entry to the Atkin Events Centre.

Mobility accessible ramp and amenities.

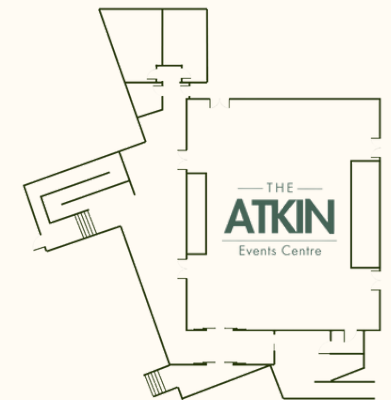



Entry to the Atkin Events Centre via the main entry to Easts Leagues Club.

Once through the entry to the club turn left down the driveway before the 2-storey parking structure.

Follow the driveway that wraps along the outside of the building.

Parking available for guests of the Atkin Events Centre.

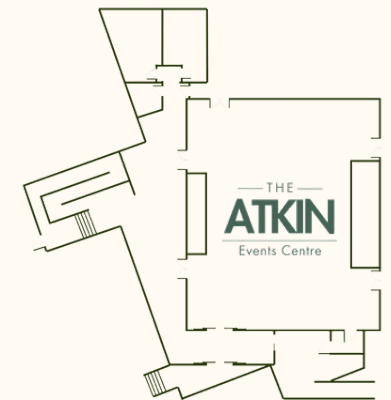
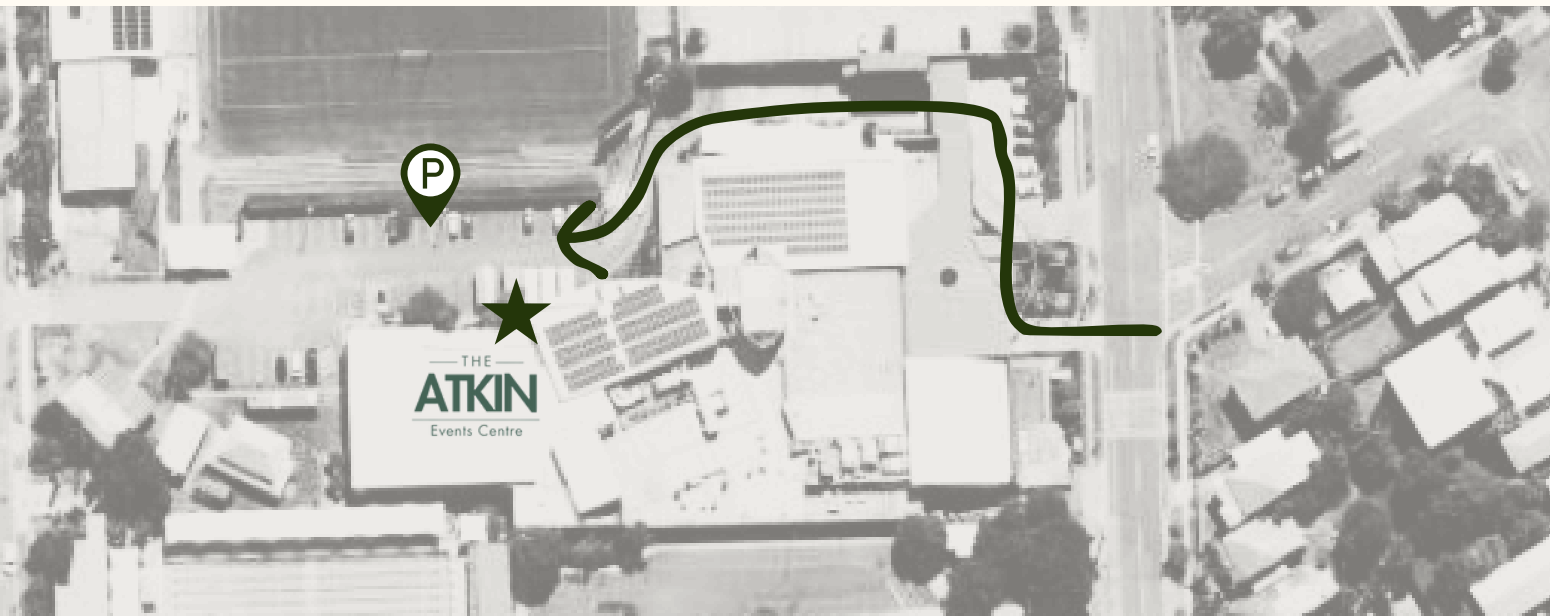

The Atkin Events Centre

30-200pax

The Atkin Events Centre is a fully private events space for a variety of functions big and small. With private parking and dedicated entry, Atkin is the destination for conferences, corporate events, workshops, seminars, special events and more.

Atkin can be accessed via stairs or ramp as a fully accessible facility complete with dedicated restrooms. Separate and secluded from the rest of the Club, your guests will forget they are in the heart of the suburbs in the private functions room.

The Jack Atkin Room is versatile with the ability to be divided in half for those smaller, more intimate events or opened to the full room for larger gatherings.

Food and beverage is sorted with our dedicated catering team ready with a wide selection of options from platters to plated and everything in between. Beverages are covered by the private double-sided bar stocked for all occasions.

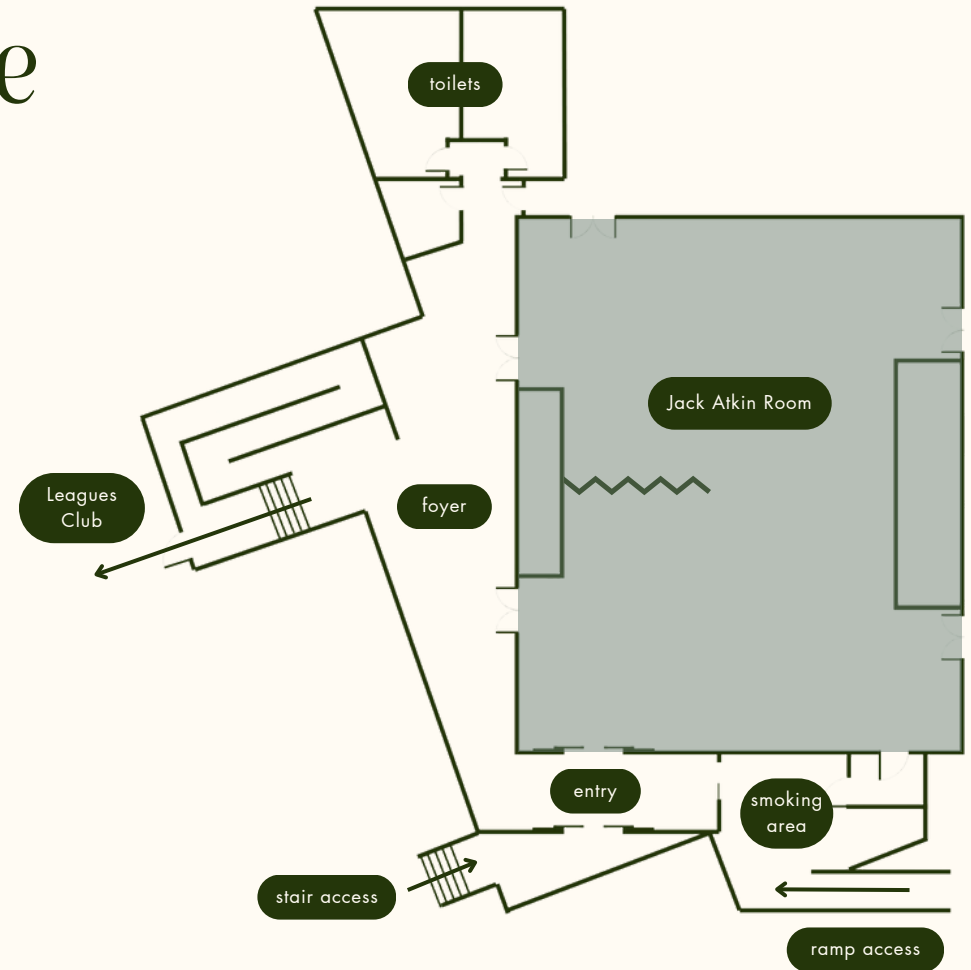

Banquet

30 - 170pax



- Capacity up to 170 guests
- 8-10 per banquet table
- Table set with white linen tablecloth and linen napkins
- Standard table decorations of hurricane vase with LED candles
- Private bar with local and craft beers on tap
- Wheelchair accessible

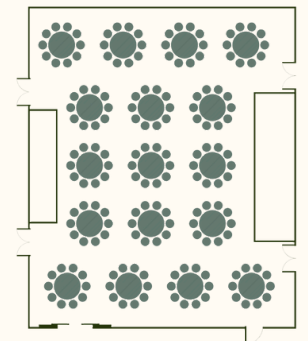

Theatre

30 - 200pax



- Capacity up to 200 guests
- Standard setting of 14 seats across with aisle through the middle
- Optional Lectern and handheld microphone, projector and screen
- Wheelchair accessible

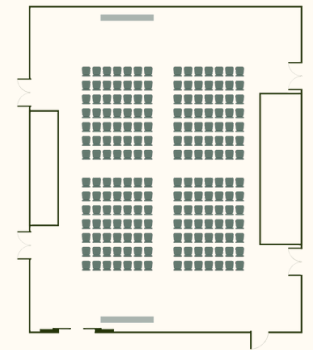

Cocktail

30 - 200pax



- Capacity up to 200 guests
- Mixed round tables and chairs, high bars and stools
- Tables set with white linen tablecloths
- Standard table decorations of hurricane vase with LED candles
- Wheelchair accessible

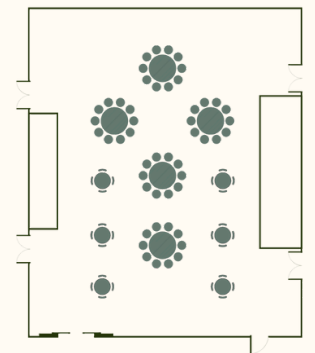

The Crossbar Terrace

25 - 60pax



- Capacity up to 60 guests
- Mixed booth seating and high bars with stools
- Airconditioned indoor terrace
- Semi-Private space with large television screen
- Large selection of local, international and craft beers on tap
- Wheelchair accessible

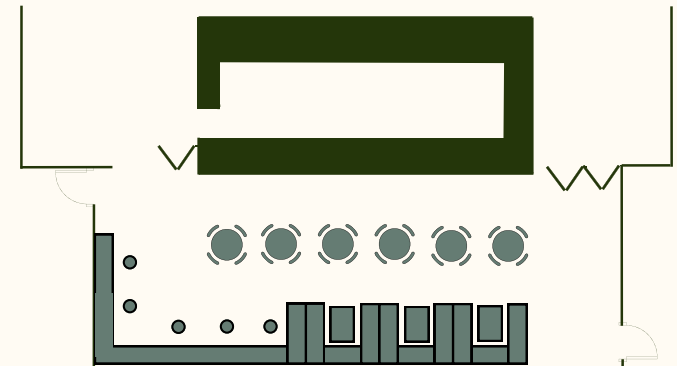

FAQs

Is there a minimum spend requirement?

No, there is no minimum spend - the cost of your functions is the room hire + catering/beverage with prices as listed

Can I bring decorations?

Absolutely! While we have simple decorations you are more than welcome to bring your own balloons, table decorations, flowers etc. However, we ask that you do not bring confetti or sparklers as they are not permitted

Can I supply my own cake?

Yes! You are welcome to bring your own cake if celebrating a birthday, wedding or special occasion. We can provide a cake display table as well as a sterling silver knife and server which you can use to serve your guests - with no cakeage fee

How big is the stage?

The stage is available in 2 sizes - full or half

the full stage is 2.4m x 4.8m

the half stage is 2.4m x 2.4m

a simple raised platform is 2.4m x 1.2m



FAQs

Am I able to supply my own music?

Yes! of course you are welcome to supply your own music, we have the capabilities to connect a laptop, tablet or phone via USB C to our built-in audio system. If looking to supply a musician or band they will be required to provide their own PA, please ensure to communicate this with your musician as we do not have a PA system on hand.

Do you have Wi-Fi available?

Yes, the club has a free guest Wi-Fi network available.

